

UTSI	COUNTY	ROUTE	POST MILES	SHEET TOTAL
			TOTAL PROJECT	NO. SHEETS
REGISTERED CIVIL ENGINEER MAY 1, 2006 PLANS APPROVAL DATE The State of California or its officers or agents shall not be responsible for the accuracy or completeness of these plans if they are used in violation of the provisions of the California Public Contract Code. To print the drawings visit us at: http://www.dgs.gov				
REGISTERED PROFESSIONAL ENGINEER JIMMIE SMITH No. 22118 Exp. 12/31/08 State of California		REGISTERED PROFESSIONAL ENGINEER JIMMIE SMITH No. 22118 Exp. 12/31/08 State of California		

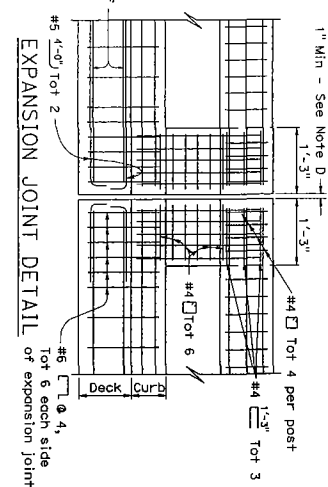

- NOTES:**
- Walls are to be backfilled before the barrier is placed.
 - Longitudinal reinforcing steel to stop at all expansion joints.
 - The front face dimensions are to be constant above the finish roadway profile, but the overall height will vary with certain thicknesses of surfacing and roadway slopes.
 - Expansion joint to match joint.
 - No lap splicing allowed on the longitudinal roll reinforcing. Splicing shall be staggered.
 - For typical metal rolling connection details not shown, see Standard Plans AT7J1 and AT7J2.
 - Chain link rolling is not allowed on Type 80 Barriers.
 - Post to be spaced equally, typically 6'-6" spacing. Post spacing may be reduced where location of hinges or expansion joints or the length of wingwalls will not accommodate the 6'-6" spacing. Maximum see-through visibility is to be strived for, where 6'-6" post spacing can not be achieved.
- STATE OF CALIFORNIA**
 DEPARTMENT OF TRANSPORTATION
CONCRETE BARRIER
TYPE 80
 (SHEET 1 OF 2)
 NO SCALE
B11-60