

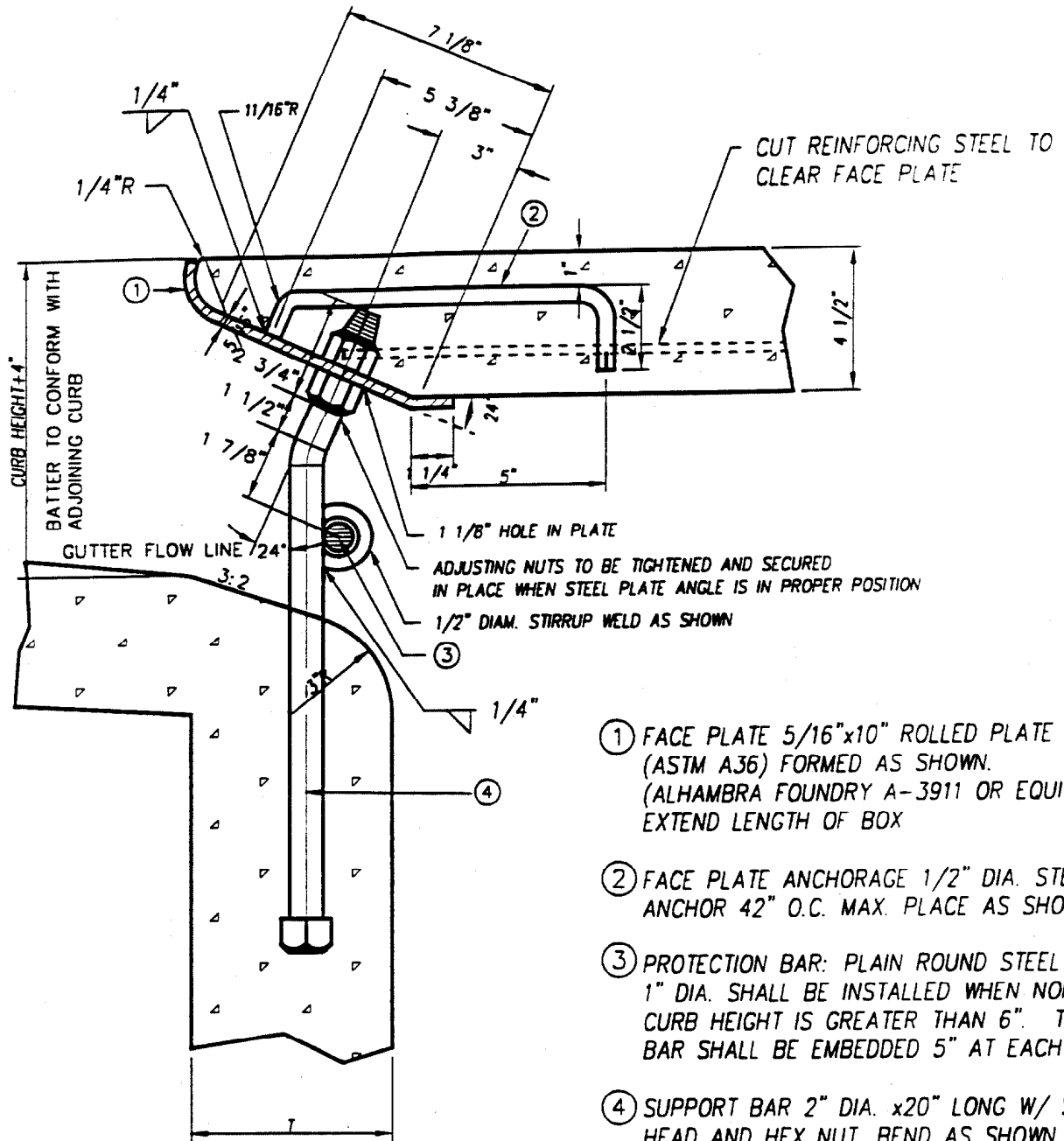

SEE RM STDS 300 & 302



SECTION THROUGH CURB FACE

- ① FACE PLATE 5/16"x10" ROLLED PLATE (ASTM A36) FORMED AS SHOWN. (ALHAMBRA FOUNDRY A-3911 OR EQUIV.) EXTEND LENGTH OF BOX
- ② FACE PLATE ANCHORAGE 1/2" DIA. STEEL ANCHOR 42" O.C. MAX. PLACE AS SHOWN
- ③ PROTECTION BAR: PLAIN ROUND STEEL BAR 1" DIA. SHALL BE INSTALLED WHEN NORMAL CURB HEIGHT IS GREATER THAN 6". THE BAR SHALL BE EMBEDDED 5" AT EACH END.
- ④ SUPPORT BAR 2" DIA. x20" LONG W/ SQ. HEAD AND HEX NUT, BEND AS SHOWN. SPACING SHALL NOT EXCEED 4 FEET.

5. ALL EXPOSED METAL PARTS SHALL BE GALVANIZED.

CITY OF RANCHO MIRAGE		STANDARD DETAIL 305
REVISIONS	CURB-SUPPORT DETAIL	
APPROVED BY: <i>William L. ...</i> 5/3/01 CITY ENGINEER DATE		