

NOTES:

1. FOR CONSTRUCTION DETAILS OF CATCH BASIN SEE STD. NO. 211,2 OF 2

Revisions	CITY OF BIG BEAR LAKE	Standard Plan No.
4	CATCH BASIN MOUNTAIN ROADS	
3		211 1 OF 2
2	APPROVED E	
1	DRAFT	
	16 OCT 89	

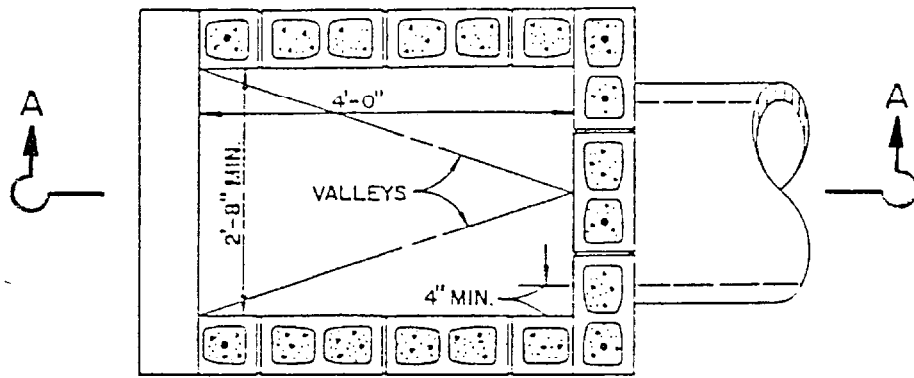

PLAN

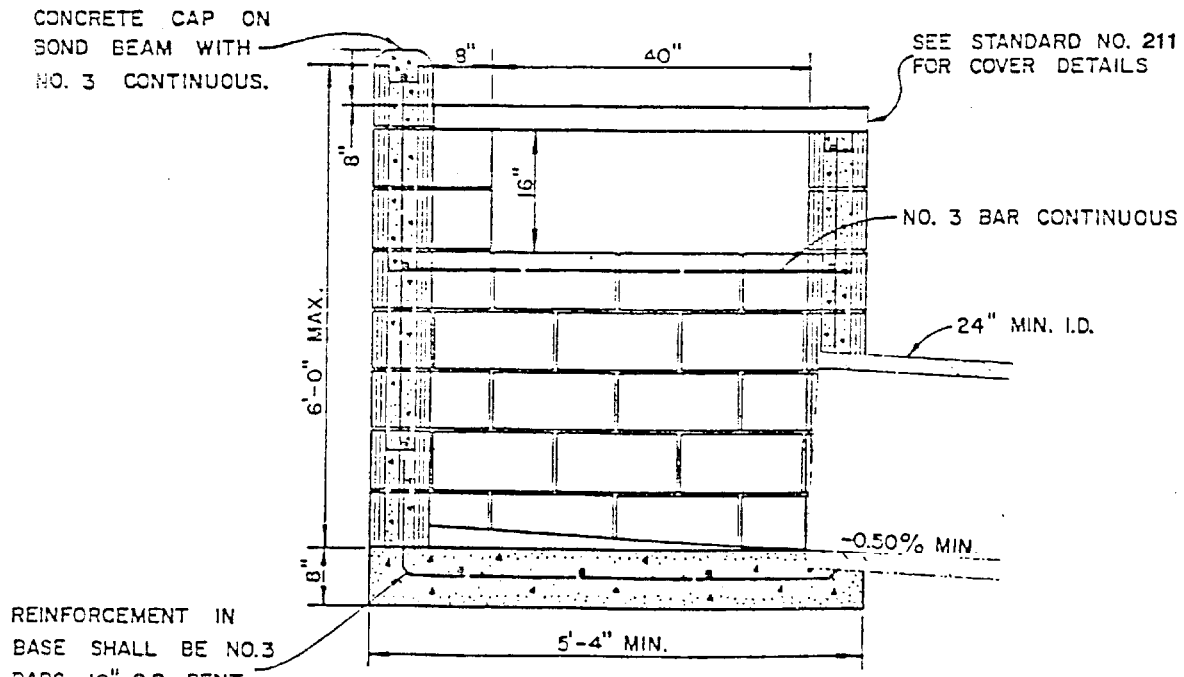

SECTION A-A

NOTES:

1. 8" x 8" x 16" CONC. BLOCK WITH NO. 3 STEEL 16" O.C. VERTICAL AND 24" O.C. HORIZONTAL.
2. FILL ALL BLOCKS WITH GROUT.
3. BASE OF CATCH BASIN SHALL BE CONSTRUCTED WITH CLASS 'B' CONCRETE.
4. HORIZONTAL STEEL SHALL BE PLACED IN BOND BEAM BLOCKS.

Revisions	CITY OF BIG BEAR LAKE	Standard Plan No.
4	CATCH BASIN MOUNTAIN ROADS	
3		211 2 OF 2
2	APPROVED E	
1	DRAFT	
	16 OCT 89	