

HALF PLAN  
SYMMETRICAL ABOUT A-A

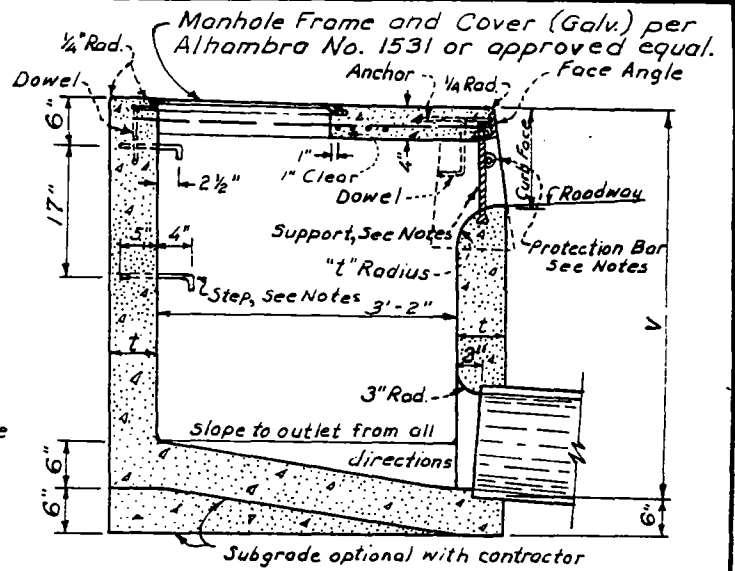

SECTION A-A

NOTES

- Connection pipes and outlet pipes may be placed in any position around the walls.
- Curvature of the lip and sidewalls at gutter opening shall be formed by curved forms.
- Dimensions  $t = 6"$  if  $V$  is  $4'-0"$  or less  
 $t = 8"$  if  $V$  is between  $4'-0"$  &  $8'-0"$   
 $t = 10"$  if  $V$  is  $8'-0"$  or more  
 $V = 4'-0"$  unless otherwise specified  
 $W = 14'-0"$  unless otherwise specified
- Floor of basin shall be troweled to a hard smooth surface and shall slope from all directions to the outlet.
- Manholes shall be placed along the back wall near outlet.
- Outlet pipe shall be trimmed to final shape and length before concrete is poured.
- Protection Bar shall be installed when curb face greater than  $10"$ ; see Dwg No. 411.
- Supports: see Dwg. No. 410.
- Steps: If  $V$  is  $3'-6"$  or less, none required. If  $V$  is  $3'-6"$  to  $4'-0"$ , place one step  $12"$  above floor. If  $V$  is more than  $4'-0"$ , place steps  $17"$  apart with top step  $6"$  below top of cover slab.
- Surface of all exposed concrete shall conform in slope, grade, color, finish, and scoring to existing or proposed curb and sidewalk adjacent to the basin.
- ③ Wall & floor steel reinforcing see Dwg. No 40B.
- Curb faces at catch basin openings shall be that of existing curb plus  $4"$  or as otherwise shown.

STEEL LIST  
ALL STEEL REINFORCING - #3 BARS

Size of Opening	Bars 1'-7" Long	Bars 3'-2" Long	Bars 3'-11" Long	Bars 6'-5" Long	Bars 9'-11" Long	Bars 13'-5" Long	Bars 14'-10" Long	Bars 21'-10" Long	Bars 28'-10" Long	Dowels, See detail	Anchors	Steps, 3/4 plain round, galv.	Protection Bar	Galvanized Support	Face Angle	Frame and Cover Set	Wall & Floor Steel reinf.
14'	3	2	28	6	0	0	3	0	0	4	5	See Note	See Note	2	15'-0"	1	See Note
21'	3	2	42	0	6	0	0	3	0	4	7	See Note	See Note	4	22'-0"	1	See Note
28'	3	2	56	0	0	6	0	0	3	4	9	See Note	See Note	5	29'-0"	1	See Note

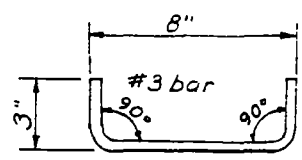

DETAIL OF DOWEL

NO.	Revision	Approved	Date
③	Rev. 3 Revised Note	<i>[Signature]</i>	4-10-61
	Rev. 2 Revised Notes	<i>[Signature]</i>	11-6-79
	Rev. 1 Revised Standard No.	<i>[Signature]</i>	8/2/78

<p>CITY OF SAN BERNARDINO - PUBLIC WORKS DEPT.</p> <h1 style="margin: 0;">CATCH BASIN NO. 3</h1>	<p>APPROVED</p> <p style="font-size: 1.5em;">6-9</p> <p style="font-size: 1.5em;">1972</p> <p><i>[Signature]</i></p> <p>CITY ENGINEER</p>	<p>STANDARD NO.</p> <h2 style="margin: 0;">405</h2>
--	---	---