

WELD 2-1/2"x38"
 SQUARE EDGE END
 BARS 3/16" FILLET
 WELD FULL DEPTH
 BOTH SIDES.

PLAN

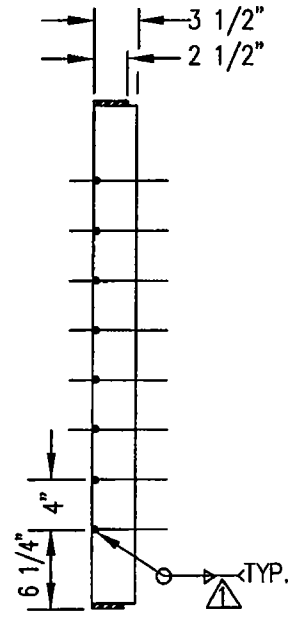

SECTION C-C

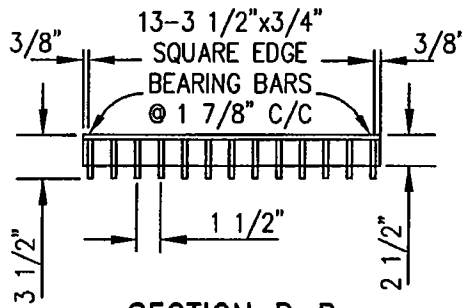

SECTION B-B

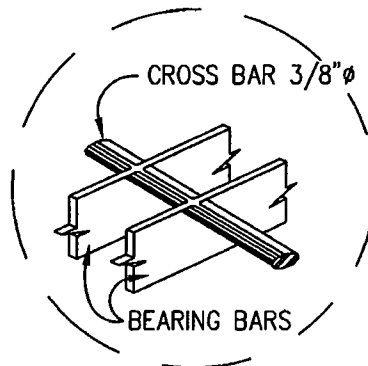

DETAIL

NOTES:

1. 3/8" CROSS BARS MAY BE FILLET WELDED, RESISTANCE WELDED, OR ELECTROFORGED TO BEARING BARS.
2. ESTIMATED WEIGHT 210 LBS.



BICYCLE TYPE FRAME AND GRATE

SCALE: NOT TO SCALE
 DATE: SEPTEMBER 13, 2006
 DRAWN BY: LDH
 V:\CAD\NEW STANDARDS

APPROVED:
Melissa Porter
 PUBLIC WORKS DIRECTOR

SHEET 1 OF 2

CD-412