

SECTIONAL ELEVATION

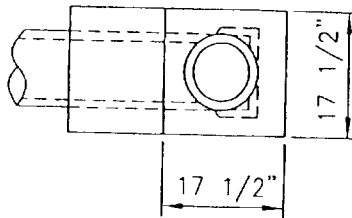

SECTION A-A

NOTES:

1. CLEANOUT FRAME & COVER, ALHAMBRA FOUNDRY NO. A-1240 OR EQUAL.
2. 3250 PSI P.C.C. TO BE USED IN ALL SEWER CONSTRUCTION.
3. THE MAXIMUM DISTANCE TO MANHOLE DOWNSTREAM SHALL BE 150'.

NOT TO SCALE

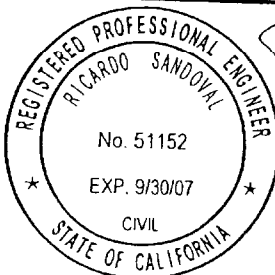

APPROVED BY: *Ricardo Sandoval* 10-18-06  
 CITY ENGINEER DATE  
**RICARDO SANDOVAL**  
 REVIEWED BY: *DG*  
 DATE OF LAST REVISION: \_\_\_\_\_

CITY OF FONTANA

SEWER TERMINAL  
 CLEANOUT

07/10/06

STD. PLAN NO. 2004

SHT 1 OF 1