

2 S.

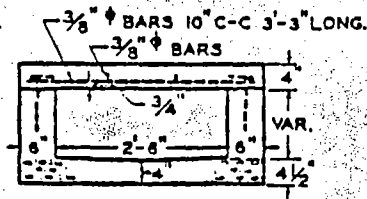

2.5 S.

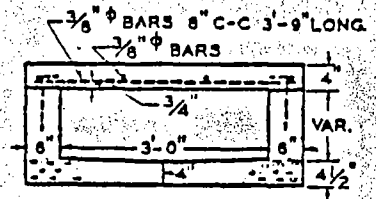

3 S.

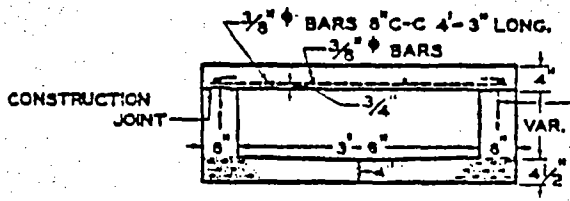

3.5 S.

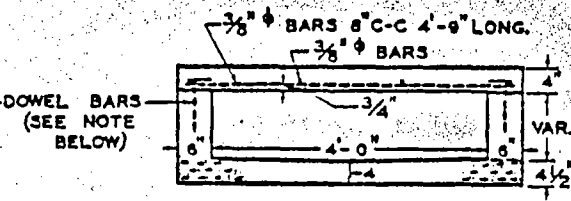

4 S.

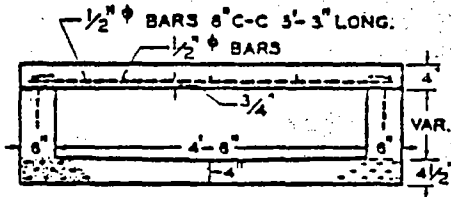

4.5 S.

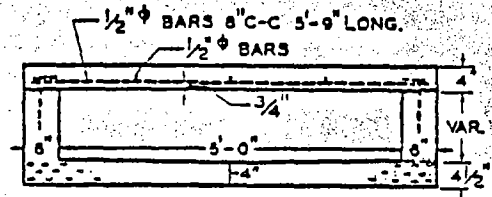

5 S.

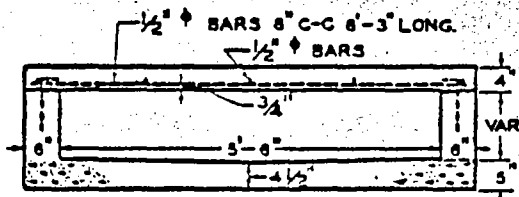

5.5 S.

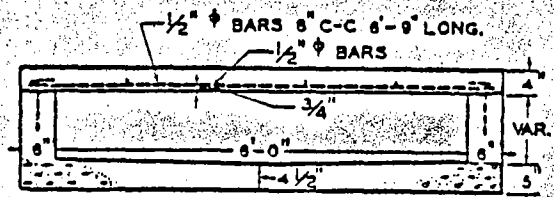

6 S.

NOTE:-

12" - 1/2" ϕ DOWEL BARS, 3" BEND AT TOP, SET 12" C-C ON CENTER LINE OF WALL AND EXTENDING DOWN 7" INTO WALL.
 CULVERT SECTIONS SHOWN ABOVE ARE DESIGNATED AS FOLLOWS:-
 2 S DENOTES A 2'-0" SIDEWALK CULVERT BOX.
 4.5 S DENOTES A 4'-6" SIDEWALK CULVERT BOX, ETC.

CITY OF PASADENA
 OFFICE OF CITY ENGINEER & SUPERINTENDENT OF STREETS

**STANDARD
 SINGLE BOX CULVERTS
 FOR SIDEWALKS.**

SUBMITTED BY *W. H. H. H.* DRAWN BY *B.H.S.*
 ASSISTANT ENGINEER CHECKED BY *D.C.M.*

APPROVED BY *H.W. H. H.*
 CITY ENGINEER & SUPT OF STREETS

DATE *JAN. 12, 1932.* **S-104**