

SECTION A-A

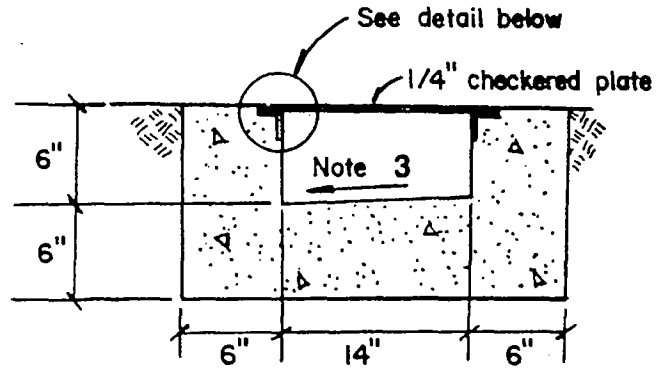

SECTION B-B

NOTES:

1. For low flows a 6" cast iron pipe may be substituted where curb is greater than or equal to 8".
2. Under sidewalk drain to be constructed at 90°. Variations from 90° require approval of the City Engineer.
3. Slope to drain to one side.
4. All exposed metal parts to be galvanized after fabrication.
5. 1 1/2" X 1 1/2" X 1/4" "L" frame with 3/8" X 1/4" steel strip welded to frame.
6. Checkered plate may be aluminum or galvanized steel.
7. Fasten with 1/4" coarse-thread flat head metal screw at 24" O.C.

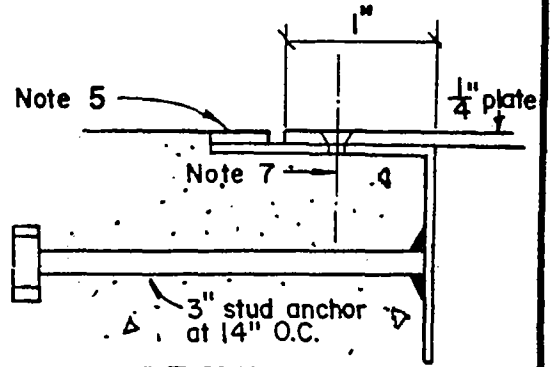

DETAIL

APPROVED *William D. ...* DATE **6-29-83**
 PUBLIC WORKS DIRECTOR - R.C.E. 10793

MARK	REVISIONS	APPR.	DATE
△	ADDED RESTRICTION ON CURB HT; ELIMINATED SEC. A-A	<i>[Signature]</i>	10-7-83
△	CHANGED 8" O.C. TO 24" O.C.; ADDED SECTION A-A.	<i>[Signature]</i>	11/2/83

CITY OF RIVERSIDE
PUBLIC WORKS DEPT. - ENGINEERING DIV.

UNDER SIDEWALK DRAIN

STANDARD DRAWING NO. 411